



Dekor 8450 V2, EndlessBeauty einziehen



EURO STYLE

Super Natural Classic V2 12 mm / AC4



Suitable for / Convient pour
Class / Classe 32, AC4 according to / selon la EN 13329



1285 x 192 x 12 mm
modern wide plank style
style moderne de type planche large

brushed and matt surface with Authentic Embossed wood pores
surface mate et brossée avec pores du bois authentiquement en relief

endless beauty with continuous wood grain patterns
beauté inaltérable avec sens continus des fibres

bevelled long edge of plank creates perfect wooden floorboard effect
parfaite optique plancher par des bords longs biseautés des panneaux

stable HDF core board with moisture protection
panneau de HDF stable avec protection contre l'humidité

25

AC4 32

Years Warranty

25 year residential and 5 year light commercial warranty according to the conditions of warranty.
Garantie de 25 ans pour les applications résidentielles et de 5 ans pour les applications commerciales légères
suivant les modalités de la garantie

Important: Basic rules before installation! Please store flat in the unopened package for at least 48 hours (min. 18°C).

Important: Regles de base avant l'installation! Entreposer a plat dans l'emballage d'origine, sans l'ouvrir, pour un minimum de 48 heures (18°C min.)



Made in Germany

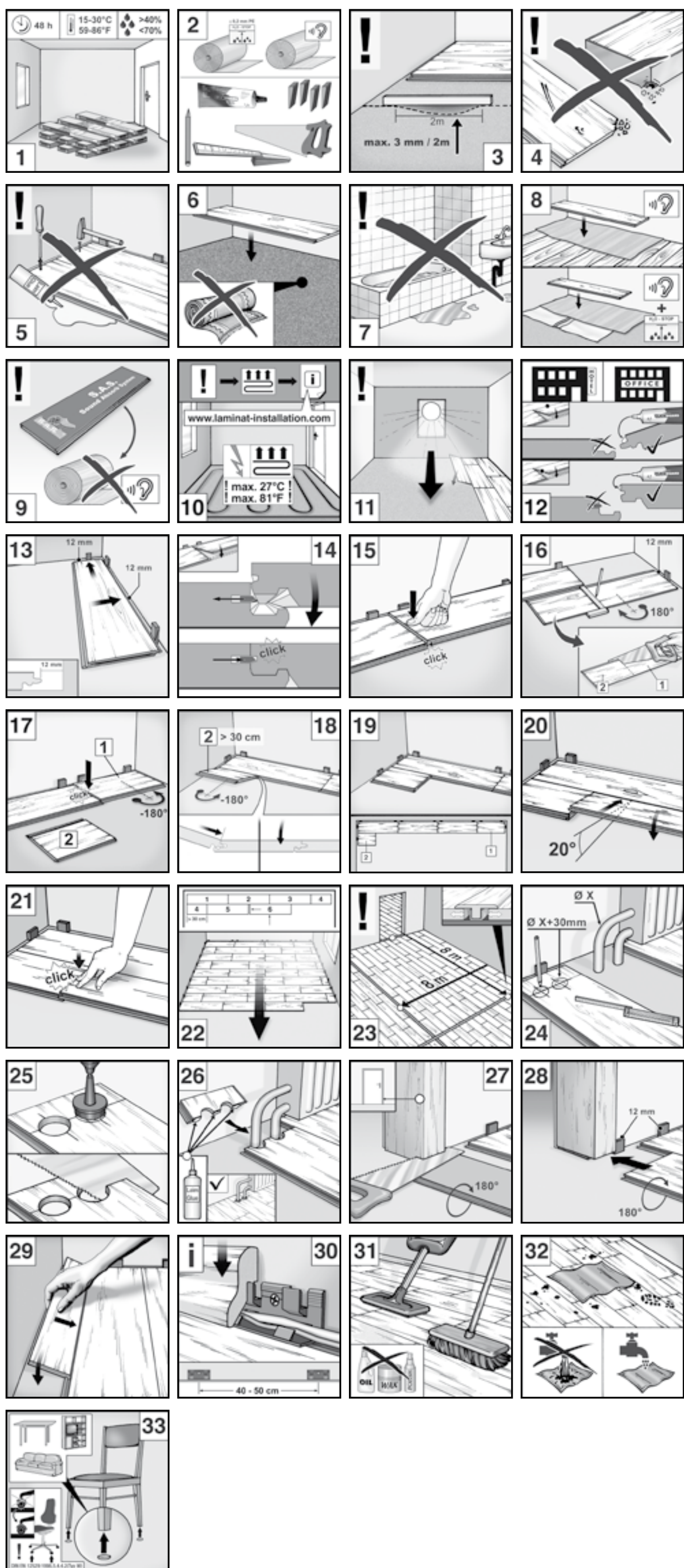

Info: www.laminat-installation.com

Disassembly:

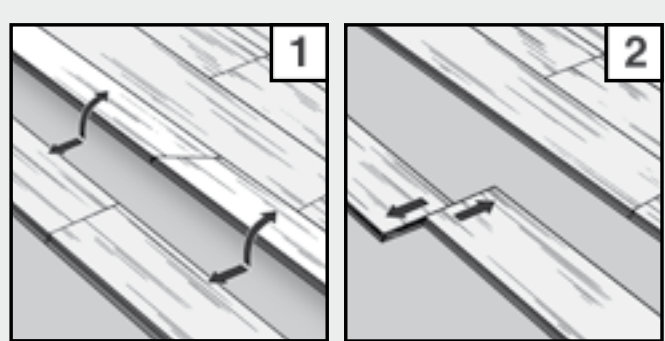

Manufacturer's Limited Warranty

The manufacturer warrants to the original end consumer, the laminate flooring panels ("panel"), from the date of the purchase, that : the décor surface of the panels will not wear through. The panels will not fade from sunlight or normal artificial lighting. The panels will resist stains. The panels are free from manufacturing defects. The limited warranty is made subject to the following conditions. This guarantee applies only to the original purchaser and proof of purchase is required for all claims. The guarantee is for replacement or refund of the laminate material only, no labour. The guarantee does not cover chipping (laminate will chip if sharp objects are dropped on it), warping (laminate will warp if excessive moisture gets into the boards) or bridging (which is caused by insufficient expansion spacing). Claims will not be considered for any of these problems. Claims for wear must be shown a minimum of one square inch area. This guarantee is prorated based on the amount of the time the floor has been installed. The laminate flooring panels must be properly installed in accordance with laminate flooring installation instructions, and must be used only for indoor areas according to their utility rating. This limited warranty does not cover negligence, improper care or maintenance, insufficient protection, improper alterations to the original materials, insects, severe accidents, exposure to extreme heat, fire and natural disasters. This limited warranty does not cover surface wear that is the result of sand or other abrasive materials. This limited warranty does not cover installations in wet areas such as bathrooms, steam rooms or any rooms exposed to excessive moisture. The limited warranty does not cover the surface wear or damage as a result of abuse, improper care and maintenance, sliding furniture or heavy objects across the floor without proper protection, severe impact, scratching, cutting or chemical damage. This limited warranty specifically excludes water damage from washing machines, urine or other corrosive liquids, excessive subsurface penetration or moisture emissions from concrete, leaking pipes or faucets, leaking appliances or receptacles such as but not limited to washing machines, bathtubs, showers, dishwashers, and refrigerators, hydrostatic pressure, flooding, natural disasters, or Acts of God. This limited warranty does not cover mouldings or accessories. This limited warranty only covers the original materials purchased. Laminate flooring panels installed with any manufacturing defects are not covered by this limited warranty. Any known manufacturing defect must be reported prior to product installation, or under any circumstance, no longer than thirty (30) days after the date of purchase to be covered under this limited warranty. Any such defective material will be replaced at no additional cost to the customer. Any damage that occurs during shipping is the responsibility of the shipping company. Any claim under this limited warranty shall be made by contacting your retailer within thirty (30) days after the defect is detected. Proof of purchase with the date of purchase must be presented with the claim. This limited warranty covers the repair or replacement, at the manufacturer's option, of the affected laminate flooring panels. If repair is not commercially practicable, or if the design or model line that is claimed for is no longer available, the manufacturer will replace the affected materials with another design or model line of equal value. This limited warranty is non-transferable, and extends only to the original end consumer. The above constitutes the customer's sole and exclusive remedy for claims under this limited warranty. This limited warranty constitutes the entire agreement between the parties.

Disclaimer of Warranty

This limited warranty does not create for or impose upon the manufacturer or its agents, any obligations or liabilities arising from any other warranties, express or implied, including merchantability or fitness for a particular purpose. The manufacturer or its agents, shall not be liable to the customer or any other person for any incidental, special, or consequential damages, and disclaims liability for breach of any other express implied warranties with respect to this product. Some jurisdictions do not allow exclusion or limitation of incidental or consequential damages, so the foregoing exclusion or limitation of incidental or consequential damages may not apply. This limited warranty gives the customer specific legal rights. Such rights may vary from one jurisdiction to another.